

U-Kühlkörper

U-shaped heatsinks

Dissipateurs en U

SK 12

1000 mm

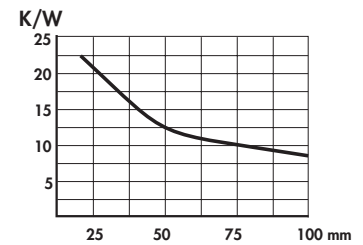
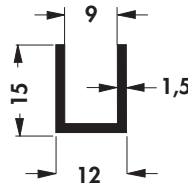

SK 192

50 1000 mm

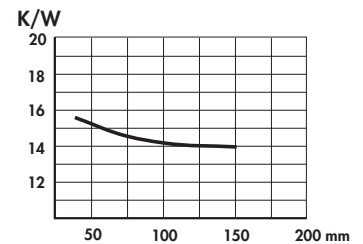
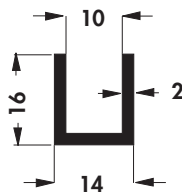

SK 13

25 35 mm

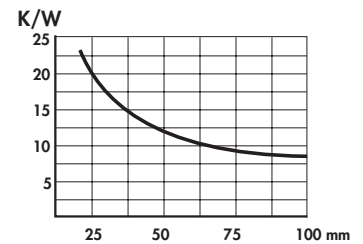
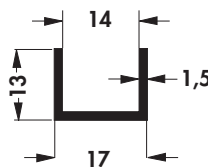

SK 115

37,5 50 1000 mm

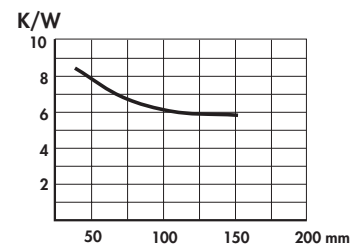
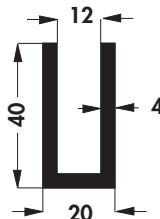

SK 116

37,5 1000 mm

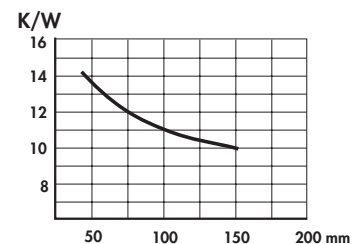
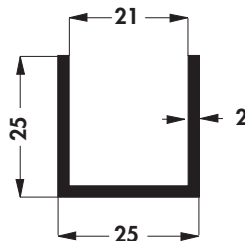

SK 114

37,5 50 1000 mm

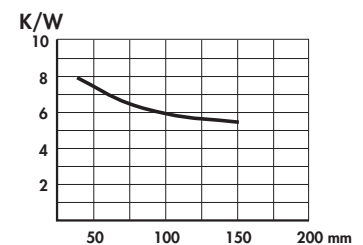
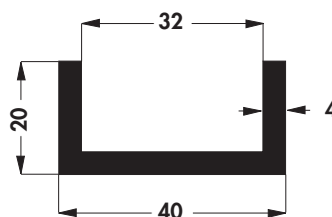

**U-Kühlkörper**

**U-shaped heatsinks**

**Dissipateurs en U**



**UK 35**  
11 K/W

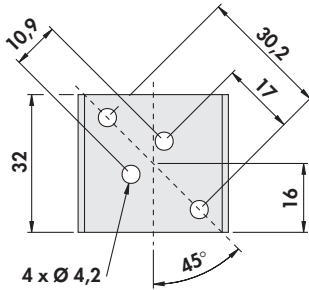
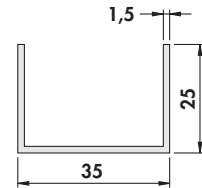

**UK 35 SA 3**  
TO 3

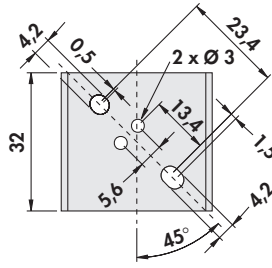

**UK 35 SA 9 66**  
SOT 9 - TO 66

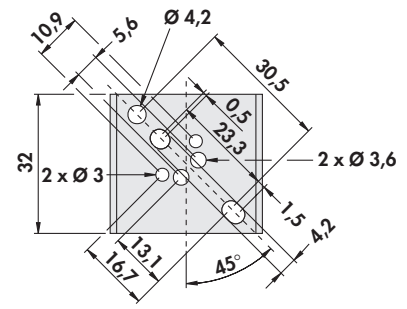

**UK 35 SA CB**  
CB (TO 3 SOT 9 - TO 66)

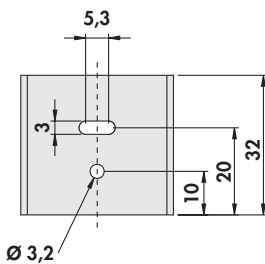

**UK 35 SA 32**  
SOT 32

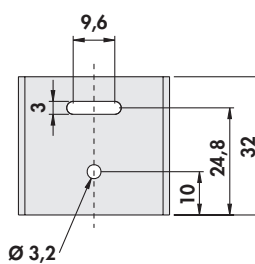

**UK 35 SA 220**  
TO 220

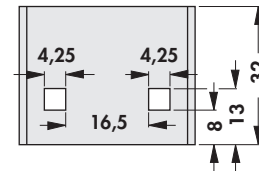

**UK 35 SA 220 C**  
TO 220  
Clip → A 93

**SK 462**

25 35 50 1000 mm

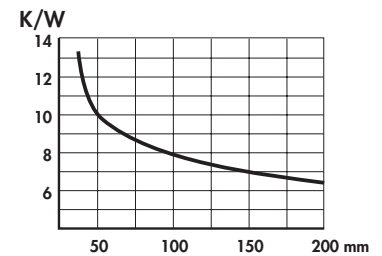
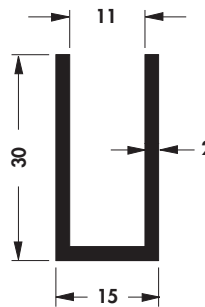

**SK 462 SA 220**

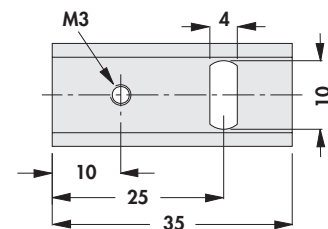
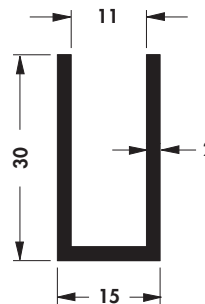

11 K/W  
TO 220

**A 123**

Transistorhaltefedern  
Aufsetzkühlkörper für TO 220, 218 u.ä.  
Aufsetzkühlkörper und Winkel für TO 3  
Lamellenkühlkörper

Retaining springs for transistors  
Set-up heatsinks for TO 220, 218 and similar  
Set-up heatsinks and angle for TO 3  
Fin coolers

Ressort de reteune pour transistors  
Dissipateurs de capôt pour transistors to 220, 218  
Dissipateurs de capôt et angle pour TO 3  
Dissipateurs à lamelles

→ A 93 - 95  
→ A 84  
→ A 125  
→ A 129 - 131

U-Kühlkörper

U-shaped heatsinks

Dissipateurs en U



**ICK 35 SA**  
15 K/W  
TO 220

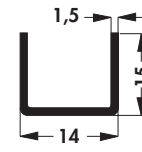
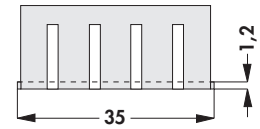
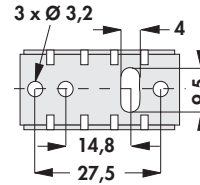
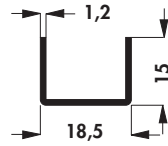

20 K/W  
TO 220

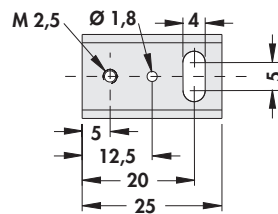

**UK 14 SA 220**

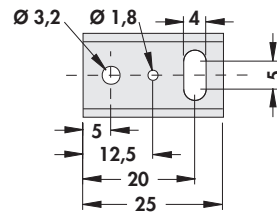

**UK 14 SA 220 3.2**

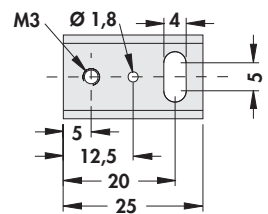

**UK 14 SA M3**

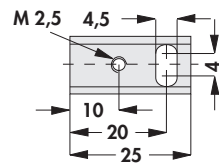
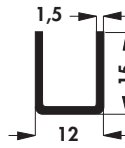

**SK 12 SA 32**  
30 K/W  
1 x SOT 32

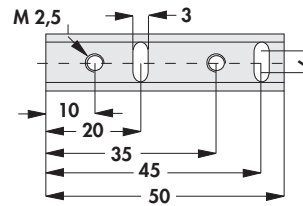

**SK 12 SA 2 x 32**  
15 K/W  
2 x SOT 32

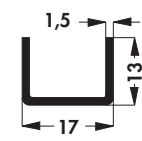

17 K/W  
TO 220

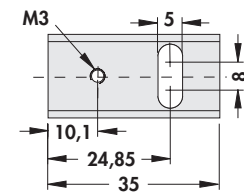

**SK 13 35 SA 220**

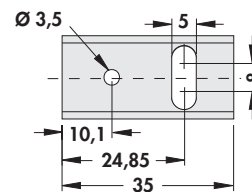

**SK 13 35 SA 220 3.5**

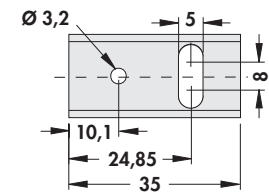

**SK 13 35 SA 220 3.2**

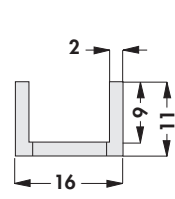

18 K/W  
TO 220

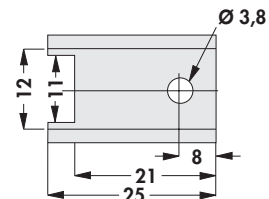

**SK 431-1**

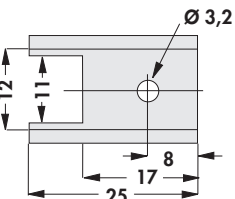

**SK 431-2**

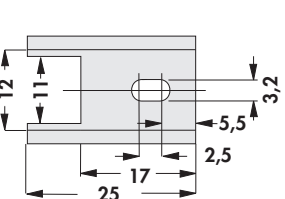

**SK 431-3**

Oberfläche schwarz eloxiert

Surface black anodised

Finition anodisée noire

Transistorhaltefedern  
Aufsetzkühlkörper für TO 220, 218 u.ä.  
Aufsetzkühlkörper und Winkel für TO 3  
Lamellenkühlkörper

Retaining springs for transistors  
Set-up heatsinks for TO 220, 218 and similar  
Set-up heatsinks and angle for TO 3  
Fin coolers

Ressort de reteune pour transistors  
Dissipateurs de capôt pour transistors to 220, 218  
Dissipateurs de capôt et angle pour TO 3  
Dissipateurs à lamelles

→ A 93 - 95  
→ A 84  
→ A 125  
→ A 129 - 131